

MASTER PARTS BOOK

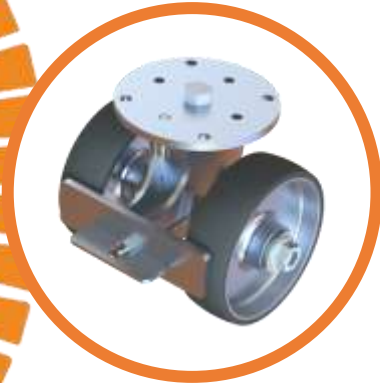

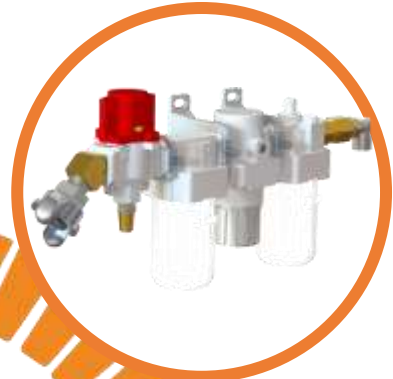

Contact Information

For information regarding the purchase, operation or repair of your product contact Bricking Solutions at:

Tel: +1-360-799-4767

Web: Brickingsolutions.com

E-MAIL: info@brickingsolutions.com

Parts: +1-360-282-3982

brickingsolutions@brickingsolutions.com / info@brickingsolutions.com

Equipment Evaluation, Training and Warranty: Jeff Mirisola—jeffm@brickingsolutions.com

We support all parts for 5 years.



CONTENTS

Installation Equipment

Shim Driver	1
Fingertip Keying Jack	1
Foot Trundle Keying Jack	3
Hand Pump Keying Jack	4
Radialign	5
Muck-It-Bucket	6

EZ Flexx50 2017—Current Parts

Master Valve	7
Cylinder Repair Kit	8
Blue Cylinders	9
Bleeder	11
Cylinder / Master Valve Hose	11
Lubricator Filter	11
Spacer Assembly	12
Hydraulic Lifting Jacks	12
Casters	12
Lights	12
Miscellaneous parts	12
Tools	13
Hardware	13
Oil	13
Fabricated / Aluminum components	14
Machine Label Set	14
Recommended Spare Parts Lists	15

Ez Flexx, MOR, EOR, POR—2016 and Earlier Parts

Hoses	17
Hydraulic Jack	17
Discontinued Cylinder Adapter	17
Hardware	18

ECOR / MECOR—Current Parts

Valve System	19
Lubricator System	19
Hoses	20
Casters / Wheels	20
Gauge	20
Fittings.....	20
Cylinders	21
Spare Parts Lists.....	22

Conveyor Parts

Parts	27
-------------	----

Old Part Numbers to New Part Number Index.....	29
---	-----------

**1894—SHIM DRIVER, KIT
PREVIOUS BBS # ASM900**

1894—SHIM DRIVER, KIT, 2 IN. STROKE

1893	HOSE, ASSEMBLY, 10', 1/2 BARB-TITE HOSE, SHIM DRIVER
1887	AIR HAMMER, RD SHANK, RED, SHIM DRIVER, 2" STROKE
1889	SHIM DRIVER HEAD, MACHINED STEEL
1890	SHANK, ROUND / ROUND, STEEL
AH301	QC COLLAR FOR SHIM DRIVER

3139—SHIM DRIVER, KIT, 1 IN. STROKE

1893	HOSE, ASSEMBLY, 10', 1/2 BARB-TITE HOSE, SHIM DRIVER
3138	AIR HAMMER, RD SHANK, RED, SHIM DRIVER, 1" STROKE
1889	SHIM DRIVER HEAD, MACHINED STEEL
1890	SHANK, ROUND / ROUND, STEEL
AH301	QC COLLAR FOR SHIM DRIVER



PART #	DESCRIPTION
1891	HOSE, 1/2 ID, BARB-TITE, BLUE

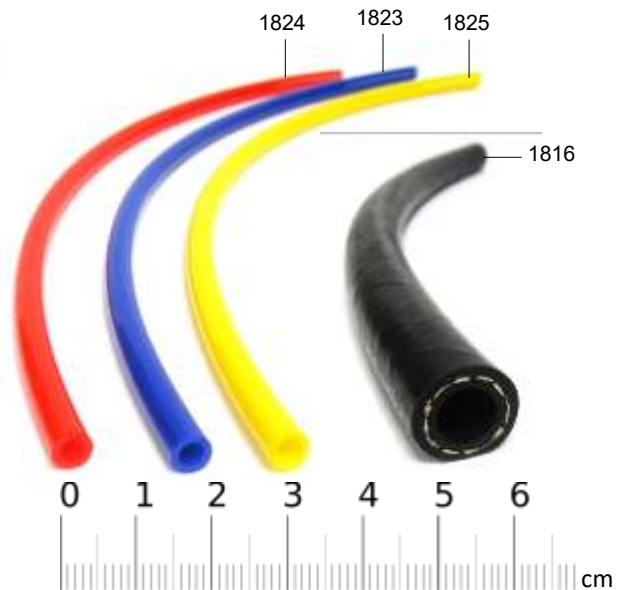

PART #	DESCRIPTION
1823	HOSE, 1/4" OD, BLUE, POLY
1824	HOSE, 1/4" OD, RED, POLY
1825	HOSE, 1/4" OD, YELLOW, POLY
1816	AIR HOSE, 3/8" ID, 21/32 OD, BLACK, PER FT
1855	ALARM, LOW AIR PRESSURE, 1/4 NPTM, BATTERY OPERATED
1821	FITTING, 1/2 NPTF, QUICK DISCONNECT, 1/2" COUPLING, STEEL, ZINC



1796—KEYING JACK, FINGER TIP CONTROLLED, KIT PREVIOUS BBS # ASM800A



1796—KEYING JACK, FINGER TIP CONTROLLED, KIT	
1797	PUMP, AIR / HYDRAULIC, PENDENT CONTROLLED
1810	CYLINDER, 10 TON, 6" STROKE, 2.24 BORE (High Flow Coupler)
1865	MANIFOLD, ASSEMBLY, KEYING JACK, FINGER TIP CONTROLLED
1864	FOOT, KEYING JACK, ASSEMBLY, BLACK
1811	HOSE CLAMP, #28, STAINLESS STEEL, 1 1/4 - 1 5/8
1812	PIPE, 1 1/4 NPTM X 9", BLACK,
1813	PIPE, 1 1/4 NPTM X 15", BLACK,
1814	PIPE, 1 1/4 NPTM X 17", BLACK,
1862	HOSE ASSEMBLY, KEYING JACK, SUPPLY HOSE, 2' LEAD
3132	HOSE ASSEMBLY, KEYING JACK, GAUGE HOSE, 10,000 PSI
1857	HOSE ASSEMBLY, KEYING JACK, CONTROL LINE, 10' LEAD
1798	MANIFOLD, 3/8 NPTM-1/4 NPTF
2544	1/4 INC, NPTF, ZINC PLATED COUPLER, FEMALE, 10,000 PSI



NOTE: KEYING JACKS PURCHASED BEFORE JUNE 2ND 2021 REQUIRE FEMALE COUPLER 2544 FOR PRESSURE GAUGE ASSEMBLY TO WORK.

1831—KEYING JACK, FOOT CONTROLLED, KIT
PREVIOUS BBS # ASM790

1831- KEYING JACK, FOOT CONTROLLED, KIT	
1827	PUMP, FOOT TREADLE, 6,000 PSI, AIR / HYDRAULIC
1810	CYLINDER, 10 TON, 6" STROKE (High Flow Coupler)
1864	FOOT, KEYING JACK, ASSEMBLY, BLACK
1812	PIPE, 1 1/4 NPTM X 9", BLACK,
1813	PIPE, 1 1/4 NPTM X 15", BLACK
1814	PIPE, 1 1/4 NPTM X 17", BLACK,
1898	HOSE, 3/8 NPTM X 10', WITH 3/8 NPTF TO 3/8" HIGH FLOW COUPLER, 10,000 PSI
3132	HOSE ASSEMBLY, KEYING JACK, GAUGE HOSE, 10,000 PSI
1863	HOSE ASSEMBLY, FOOT TREADLE KEYING JACK, SUPPLY HOSE, 10'
1798	MANIFOLD, 3/8 NPTM-1/4 NPTF
2544	1/4 INC, NPTF, ZINC PLATED COUPLER, FEMALE, 10,000 PSI



NOTE: KEYING JACKS PURCHASED BEFORE JUNE 2ND 2021 REQUIRE FEMALE COUPLER 2544 FOR PRESSURE GAUGE ASSEMBLY TO WORK.

INSTALLATION EQUIPMENT



1897—KEYING JACK, HAND PUMP, KIT, WITH GAUGE



1897—KEYING JACK, HAND PUMP, KIT, WITH GAUGE	
1896	PUMP, HAND, 6,000 PSI, 21CU INCH, RED
1810	CYLINDER, 10 TON, 6" STROKE, 2.24 BORE
1864	FOOT, KEYING JACK, ASSEMBLY, BLACK
1812	PIPE, 1 1/4 NPTM X 9", BLACK,
1813	PIPE, 1 1/4 NPTM X 15", BLACK,
1814	PIPE, 1 1/4 NPTM X 17", BLACK,
3133	GAUGE ASSEMBLY, KEYING JACK, HAND PUMP, 10,000 PSI
1973	HOSE, ASSEMBLY, 10', HAND PUMP, HYDRAULIC, WITH GAUGE
2544	1/4 INC, NPTF, ZINC PLATED COUPLER, FEMALE, 10,000 PSI

NOTE

KEYING JACKS PURCHASED BEFORE JUNE 2ND 2021 REQUIRE FEMALE COUPLER 2544 FOR PRESSURE GAUGE ASSEMBLY TO WORK.

HOSE ASSEMBLY 1973 PURCHASED BEFORE JUNE 2021 MAY REQUIRE COUPLER 2543 FOR PRESSURE GAUGE TO WORK

GAUGE ASSEMBLY 3133 PURCHASED BEFORE JUNE 2021 MAY REQUIRE COUPLER 2544 FOR PRESSURE GAUGE TO WORK

2385—KEYING JACK, HAND PUMP 2 IN STROKE, KIT, WITH GAUGE

2385—KEYING JACK, HAND PUMP 2 IN STROKE, KIT, WITH GAUGE	
1896	PUMP, HAND, 6,000 PSI, 21CU INCH, RED
2070	CYLINDER, 10 TON, HYDRAULIC, 2 IN STROKE, 2.24 BORE
1864	FOOT, KEYING JACK, ASSEMBLY, BLACK
3133	GAUGE ASSEMBLY, KEYING JACK, HAND PUMP, 10,000 PSI
1973	HOSE, ASSEMBLY, 10', HAND PUMP, HYDRAULIC, WITH GAUGE
2544	1/4 INC, NPTF, ZINC PLATED COUPLER, FEMALE, 10,000 PSI



NOTE

KEYING JACKS PURCHASED BEFORE JUNE 2ND 2021 REQUIRE FEMALE COUPLER 2544 FOR PRESSURE GAUGE ASSEMBLY TO WORK.

HOSE ASSEMBLY 1973 PURCHASED BEFORE JUNE 2021 MAY REQUIRE COUPLER 2543 FOR PRESSURE GAUGE TO WORK

GAUGE ASSEMBLY 3133 PURCHASED BEFORE JUNE 2021 MAY REQUIRE COUPLER 2544 FOR PRESSURE GAUGE TO WORK

**1885—MASTER VALVE, ASSEMBLY,
PLACING ARCH, BLUE—PREVIOUS BBS # ASM463FS**

**1886—MASTER VALVE, ASSEMBLY,
HOLDING ARCH, BLUE—PREVIOUS BBS # ASM463BS**

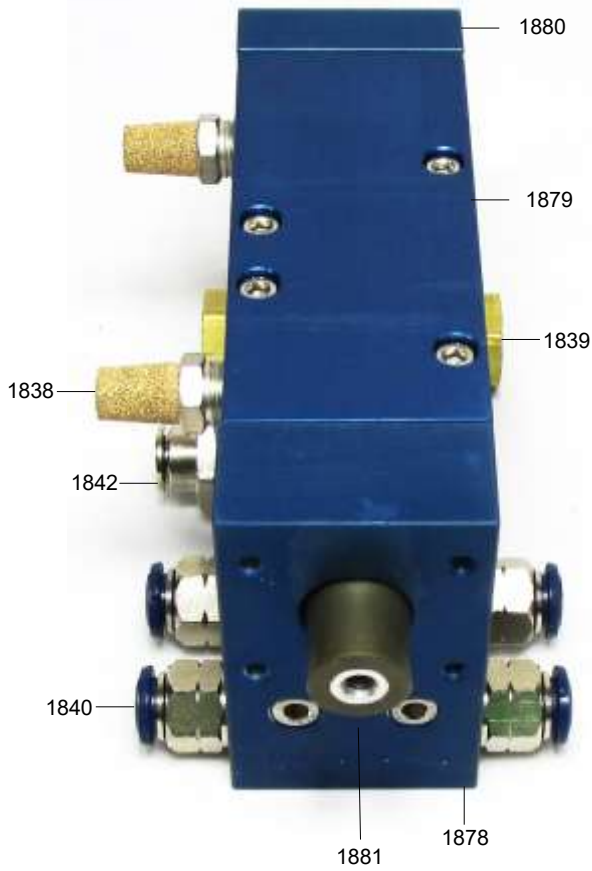

(Knob not shown)

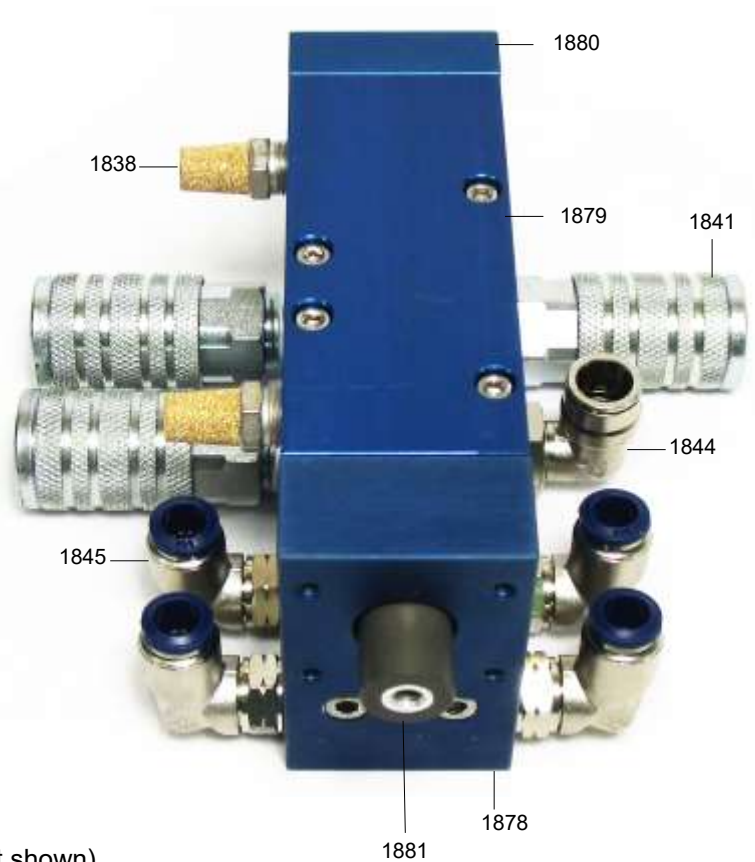

1885- MASTER VALVE, ASSEMBLY, PLACING ARCH, BLUE	
1878	MASTER VALVE, MANIFOLD, 3 WAY VALVE, BLUE
1879	MASTER VALVE, BODY, 3 WAY, BLUE
1880	MASTER VALVE, END CAP, BLUE
1881	MASTER VALVE, SHUTTLE, 3 WAY, HARD COAT CLEAR
1666	SCREW, SHC, 10-32 X 5/8, STAINLESS STEEL 18-8
1663	SCREW, SHC, 10-32 x 2.0, STAINLESS STEEL, GRADE 18-8, PLAIN
1883	O-RING, MASTER VALVE, CUSTOM
1882	O-RING, -110, BUNA-N, .362ID X .103 CORD
1838	FITTING, MUFFLER, 1/4 NPTM
1839	FITTING, PLUG, 1/2 NPTM, HEX, BRASS
1840	FITTING, 3/8 UNPTM TO 3/8 HOSE, PUSH TO CONNECT, BRASS, NICKEL PLATED
1842	FITTING, 3/8 PUSH LOCK TO, 1/2 NPTM, ADAPTOR
1843	KNOB, 1/4-20 X 7/16, 1 3/8 OD, PVC, BLACK

1886—MASTER VALVE, ASSEMBLY, HOLDING ARCH, BLUE	
1878	MASTER VALVE, MANIFOLD, 3 WAY VALVE, BLUE
1879	MASTER VALVE, BODY, 3 WAY, BLUE
1880	MASTER VALVE, END CAP, BLUE
1881	MASTER VALVE, SHUTTLE, 3 WAY, HARD COAT CLEAR
1666	SCREW, SHC, 10-32 X 5/8, STAINLESS STEEL 18-8
1663	SCREW, SHC, 10-32 x 2.0, STAINLESS STEEL, GRADE 18-8, PLAIN
1883	O-RING, MASTER VALVE, CUSTOM
1882	O-RING, -110, BUNA-N, .362ID X .103 CORD
1838	FITTING, MUFFLER, 1/4 NPTM
1839	FITTING, PLUG, 1/2 NPTM, HEX, BRASS
1845	FITTING, 3/8 PUSH LOCK TO, 3/8 UNPTM, 90°, SWIVEL
1841	FITTING, INDUSTRIAL 1/2 QUICK CONNECT, FEMALE, TO 1/2 NPTM, STEEL
1843	KNOB, 1/4-20 X 7/16, 1 3/8 OD, PVC, BLACK
1844	FITTING, ELBOW , 1/2 NPTM - 1/2 TUBE, 90°, SWIVEL, BRASS, NICKEL



MASTER VALVE



PART #	DESCRIPTION
1878	MASTER VALVE, MANIFOLD, 3 WAY VALVE, BLUE
1879	MASTER VALVE, BODY, 3 WAY, BLUE
1880	MASTER VALVE, END CAP, BLUE
1881	MASTER VALVE, SHUTTLE, 3 WAY, HARD COAT CLEAR
1883	O-RING, MASTER VALVE, CUSTOM
1882	O-RING, -110, BUNA-N, .362ID X .103 CORD
1918	KIT, MASTER VALVE, REBUILD, O-RING REPLACEMENT, BLUE
1843	KNOB, 1/4-20 X 7/16, 1 3/8 OD, PVC, BLACK
1663	SCREW, SHC, 10-32 x 2.0, STAINLESS STEEL, GRADE 18-
1666	SCREW, SHC, 10-32 X 5/8, STAINLESS STEEL 18-8



Mounting Hardware



1928—KIT, ROTOR REPLACEMENT, VALVE IN BASE CYLINDER



1928—KIT, ROTOR REPLACEMENT, VALVE IN BASE CYLINDER	
1877	HANDLE, CYLINDER, STAINLESS STEEL, WITH BALL
1923	PIN, 1/8 X 3/4, STAINLESS STEEL 18-8
1924	SHAFT, ROTOR, VALVE BASE CYLINDER, STAINLESS STEEL
1925	WASHER, .313ID .637 OD X .067
1926	SPRING, .480 OD X .75 FREE, 146.9 LB/IN, ZINC
1791	ROTARY VALVE, CYLINDER, HDPE

1856—CYLINDER, ASSEMBLY, 40MM X 8.0", AL, BLUE, WITH FASTENERS AND HANDLE
PREVIOUS BSS # ASM4058S / ASM4058



1856—CYLINDER, ASSEMBLY, 40MM X 8.0", AL, BLUE, WITH FASTENERS AND HANDLE

1869	CYLINDER, 40MM X 8.0", VALVE IN BASE, AL BLUE
1870	BUMPER, 5.8 X 1.5 X 1.3, 65A DIR, ROD MOUNT
1872	ROD, ANTI TURN, 8" CYLINDER, STAINLESS STEEL
1873	RETAINING RING, EXTERNAL, .25 SHAFT, STEEL, BLACK PHOSPHATE
1874	BRACKET, ANTI TURN, ALUMINUM, BUMPER MOUNT
1875	BUSHING, ANTI TURN, STAINLESS STEEL 18-8, #10
1877	HANDLE, CYLINDER, STAINLESS STEEL, WITH BALL
1845	FITTING, 3/8 PUSH LOCK TO, 3/8 UNPTM, 90°, SWIVEL
1923	PIN, 1/8 X 3/4, STAINLESS STEEL 18-8
1924	SHAFT, ROTOR, VALVE BASE CYLINDER, STAINLESS STEEL
1925	WASHER, .313ID .637 OD X .067
1926	SPRING, .480 OD X .75 FREE, 146.9 LB/IN, ZINC
1791	ROTARY VALVE, CYLINDER, HDPE, ORANGE
1667	SCREW, SHC, 10-32 X 1
1867	SPACER, .3125OD X .375, .193ID, ALUMINUM
1666	SCREW, SHC, 10-32 X 5/8
1683	SCREW, SHC 10-32 X 1.5, STAINLESS STEEL 18-8

Mounting Hardware



Ez FI exx50 2017 - Current Parts



1876—CYLINDER, ASSEMBLY, 40MM X 6.0", AL, BLUE, WITH FASTENERS AND HANDLE PREVIOUS BSS # ASM4056S / ASM4056

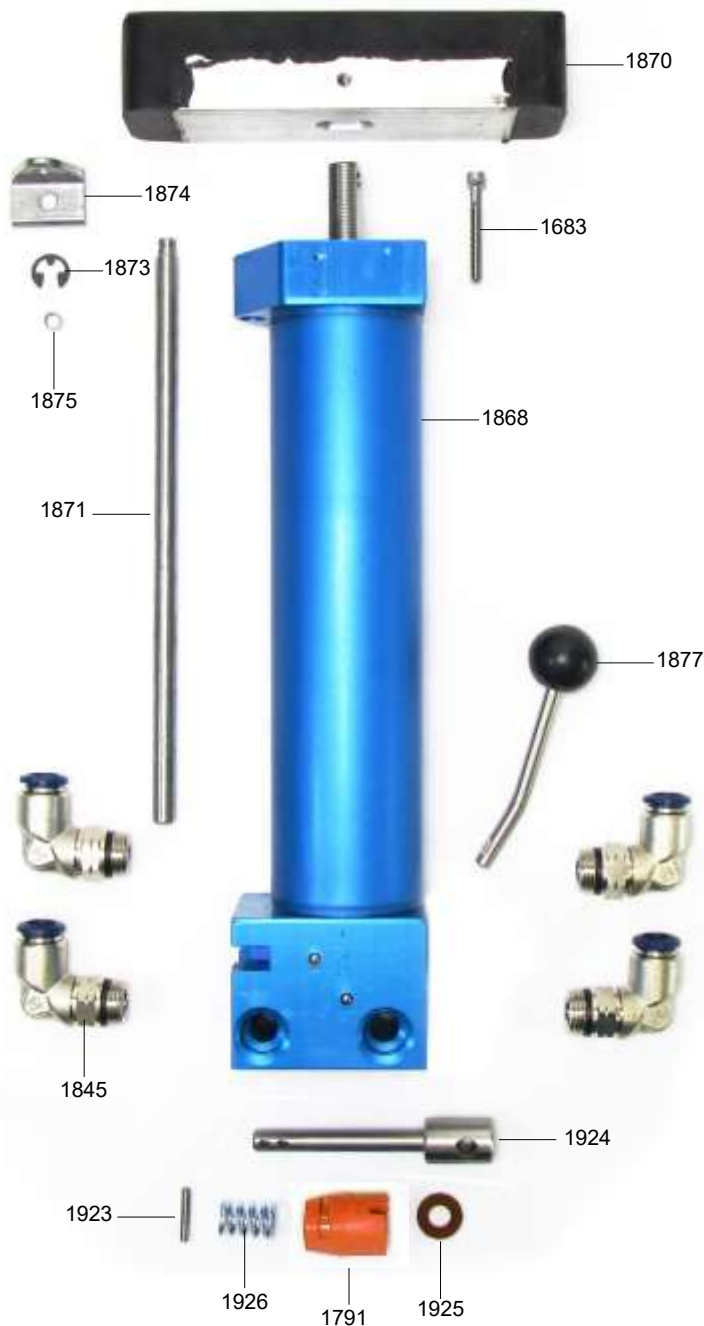

Mounting Hardware



1876—CYLINDER, ASSEMBLY, 40MM X 6.0", AL, BLUE, WITH FASTENERS AND HANDLE

1868	CYLINDER, 40MM X 6.0", VALVE IN BASE, AL BLUE
1870	BUMPER, 5.8 X 1.5 X 1.3, 65A DIR, ROD MOUNT
1871	ROD, ANTI TURN, 6" CYLINDER, STAINLESS STEEL
1873	RETAINING RING, EXTERNAL, .25 SHAFT, STEEL, BLACK PHOSPHATE
1874	BRACKET, ANTI TURN, ALUMINUM, BUMPER MOUNT
1875	BUSHING, ANTI TURN, STAINLESS STEEL 18-8, #10
1877	HANDLE, CYLINDER, STAINLESS STEEL, WITH BALL
1845	FITTING, 3/8 PUSH LOCK TO, 3/8 UNPTM, 90°, SWIVEL
1923	PIN, 1/8 X 3/4, STAINLESS STEEL 18-8
1924	SHAFT, ROTOR, VALVE BASE CYLINDER, STAINLESS STEEL
1925	WASHER, .313ID .637 OD X .067
1926	SPRING, .480 OD X .75 FREE, 146.9 LB/IN, ZINC
1791	ROTARY VALVE, CYLINDER, HDPE
1667	SCREW, SHC, 10-32 X 1
1867	SPACER, .3125OD X .375, .193ID, ALUMINUM
1666	SCREW, SHC, 10-32 X 5/8
1683	SCREW, SHC 10-32 X 1.5, STAINLESS STEEL 18-8

1910—BLEEDER, ASSEMBLY, TWO LINE, 3/8 TUBE, BLACK

1910—BLEEDER, ASSEMBLY, TWO LINE, 3/8 TUBE, BLACK

1908	FITTING, 1/4 NPTF TO, 3/8 PUSH TO CONNECT HOSE, NICKEL PLATED, BRASS
1909	FITTING, BLEEDER, 1/4 NPTM, SS, KNURLED



CYLINDER / MASTER VALVE HOSE

PART #	DESCRIPTION
1912	HOSE, 3/8 OD, BLUE, POLY
1911	HOSE, 3/8 OD, RED, POLY
2245	HOSE, 3/8 OD, ORANGE, POLY
1913	HOSE, ASSEMBLY, CROSS OVER, 3'

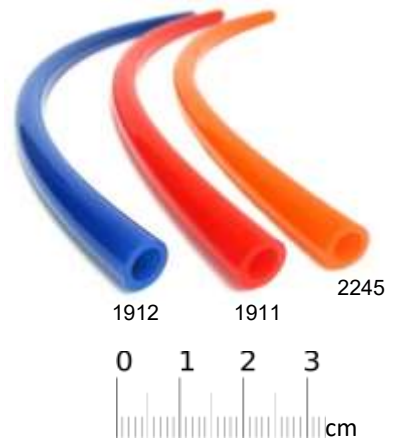
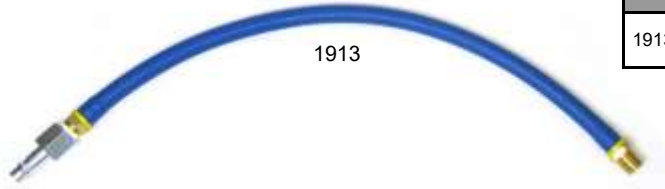

LUBRICATOR SYSTEM

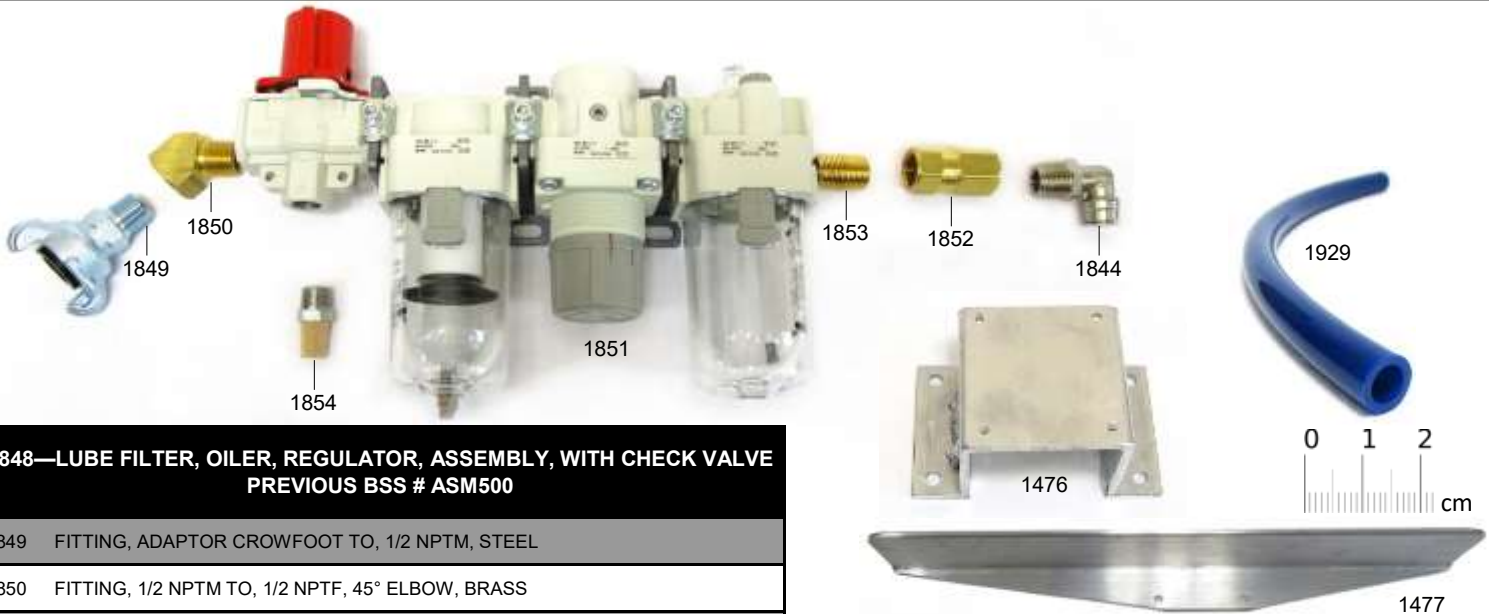

1848—LUBE FILTER, OILER, REGULATOR, ASSEMBLY, WITH CHECK VALVE PREVIOUS BSS # ASM500

1849	FITTING, ADAPTOR CROWFOOT TO, 1/2 NPTM, STEEL
1850	FITTING, 1/2 NPTM TO, 1/2 NPTF, 45° ELBOW, BRASS
1851	LUBE FILTER, OILER, REGULATOR, ASSEMBLY, WITH MOUNTS
1852	FITTING, CHECK VALVE, 1/2 MPTF TO, 1/2 NPTF, BRASS, ONE WAY VALVE
1853	FITTING, 1/2 NPTM PIPE NIPPLE, 1 1/2 LONG, BRASS
1854	FITTING, MUFFLER, 3/8 NPTM
1844	FITTING, 1/2 PUSH LOCK TO, 1/2 NPTM, 90°, SWIVEL

PART #	DESCRIPTION
1476	BRACKET, WELDMENT, LUBE OIL FILTER, MOUNT, WITH FASTENERS
1477	GUARD, LUBE OIL FILTER
1929	HOSE, 1/2 OD, POLY, BLUE



ARCH SPACER

1900	SPACER, ASSEMBLY, FLEX BEARINGS, AL ACME SCREW, WITH FASTENERS, KIT—PREVIOUS BBS # ASM450
1904	BEARING, 1.0 ID, FACE MOUNT, 2 BOLT, STEEL, FLEX BEARING, TAPPED TO M14
1901	ANTI TURN, SPACER ASSEMBLY, AL CAST
1902	BOLT, SPACER ASSEMBLY, 3/4-5 LH, ALUMINUM
1903	BEARING, 3/4 ID, FACE MOUNT, 2 BOLT, STEEL, FLEX BEARING, TAPPED TO M14
1694	SCREW, HHC, M14-2 X 60
1693	SCREW, HHC, M14-2 x 30, GRADE 5, ZINC
1718	WASHER, FLAT, M14, ZINC

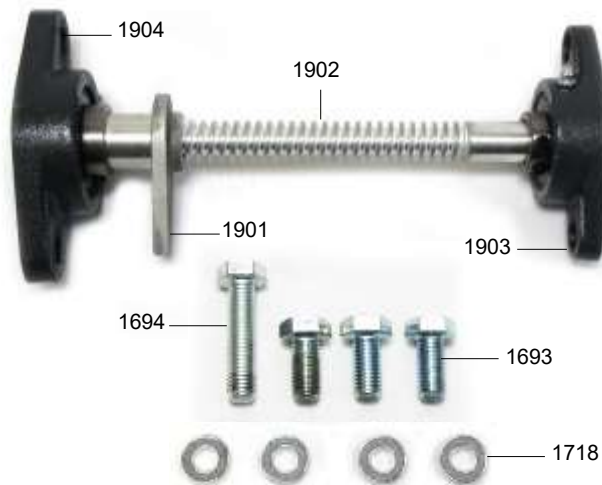

MISCELLANEOUS PARTS

PART #	DESCRIPTION
1916	JACK, FLAT BOTTOM, 3 TON, 19" STROKE
1917	JACK, KNUCKLE BOTTOM, 3 TON, 19" STROKE
1784	LIGHT, LED, 50W, beam angle 110°, color 5000K
1970	WHEEL, 2 X 6", V-GROOVE, STEEL, CASTER WHEEL,
2221	FDEOR SMALL—CASTER, 8 X 3 WHEEL, 0 OFFSET, WITH BREAK, WITH SWIVEL LOCK, 2500 LB CAPACITY
2037	CASTER, 4000 LBS., 2 WHEEL, ALUMINUM BODY, BLACK WHEEL
1968	MACHINE GAUGE



May require grinding down on attachment point



1790—TOOL BOX ASSEMBLY



1790—TOOL BOX ASSEMBLY

1785	TOOL BOX, 19 X 10 X 9, BLACK
1972	HAMMER, DEAD BLOW, 4 LB, NEON ORANGE
1977	TOOL, SPRING DEPRESSOR, CLAMP, STEEL
1979	TOOL, HEX KEY, 5/32, BLACK PHOSPHATE STEEL, L SHAPE
1980	TOOL, HEX KEY, 1/8, BLACK PHOSPHATE, STEEL, L SHAPE
1788	PLIERS, LONG NOSE, 8"
1787	ALIGNMENT TOOL, 5/16 X 12"
2512	SOFT FACE DEAD BLOW 3 LB
1907	TOOL, SPEED WRENCH



HARDWARE / OIL

PART #	DESCRIPTION
1606	PIN, HITCH, 5/8 X 5.0
1210	PIN, HITCH 1/2 X 4 1/4, EFFECTIVE LENGTH, YELLOW ZINC PLATED
1978	PIN, LYNCH, 3/16 RING, YELLOW ZINC
2056	PIN, 3/8 X 2 1/2(USABLE),BALL DETENT, SS 18-8, WITH LANYARD
1209	PIN, CLEVIS PIN, 3/4 X 5, 4.76 EFFECTIVE, STEEL, ZINC
2248	PIN SET, 5/8 X 5, BRICKING MACHINE, EOR 4M—6M

PART #	DESCRIPTION
1899	OIL, HYDRAULIC, 15 LF OZ, 443mL, ISO 32
1983	OIL, AIR TOOL, 15OZ, ISO 32





MACHINE COMPONENTS

PART #	DESCRIPTION
2050	FALL GUARD, SINGLE END, MADE TO ORDER, MACHINE SERIAL NUMBER REQUIRED
2339	LADDER
2036	SCREW JACK, ARCH, MADE TO ORDER, MACHINE SERIAL NUMBER REQUIRED
3048	12 IN X 168 IN DECK PANEL WITH END CAPS
3049	12 IN X 168 IN DECK PANEL WITH END CAPS AND ANGLE
3050	12 IN X 204 IN DECK PANEL WITH END CAPS
3051	12 IN X 204 IN DECK PANEL WITH END CAPS AND ANGLE
3052	7 IN X 168 IN DECK PANEL WITH END CAPS
3053	7 IN X 204 IN DECK PANEL WITH END CAPS
2458	10 IN X 204 DECK PANEL WITH END CAPS (6000 KG MACHINE)
2573	5 IN X 204 DECK PANEL WITH END CAPS (6000 KG MACHINE)
2620	10 IN X 168 DECK PANEL WITH END CAPS (4000 KG MACHINE)
2250	5 IN X 168 DECK PANEL WITH END CAPS (4000 KG MACHINE)
2738	10 IN X 144 DECK PANEL WITH END CAPS (2700 KG MACHINE)
2737	5 IN X 144 DECK PANEL WITH END CAPS (2700 KG MACHINE)



FALL GUARDS ARE CUSTOM BUILT TO YOUR MACHINES SERIAL NUMBER



Planking



MACHINE LABEL SET

YOUR MACHINES SERIAL NUMBER IS REQUIRED. FULL LABEL SET NOT SHOWN

SAFETY GUIDELINES

- PRINCIPLES OF SAFE OPERATION CONTAINED IN THE MANUAL.
- ENSURE THAT NATIONAL AND LOCAL SAFETY REGULATIONS, PRECAUTIONS, AND OTHER INSTRUCTIONS ARE FOLLOWED WHEN THE MACHINE IS USED.
- INSPECT THE WORK PLATFORM AND ARCH BEFORE, DURING, AND AFTER EACH USE IN ACCORDANCE WITH THE MAINTENANCE SECTION OF THE MANUAL.

SAFETY GUIDELINES

- SUPERVISORS AND ALL PERSONNEL MUST LEARN AND PRACTICE THE PRINCIPLES OF SAFE OPERATION CONTAINED IN THE MANUAL.
- ENSURE THAT NATIONAL AND LOCAL SAFETY REGULATIONS, PRECAUTIONS, AND OTHER INSTRUCTIONS ARE FOLLOWED WHEN THE MACHINE IS USED.
- INSPECT THE WORK PLATFORM AND ARCH BEFORE, DURING, AND AFTER EACH USE IN ACCORDANCE WITH THE MAINTENANCE SECTION OF THE MANUAL.

SAFETY GUIDELINES

- SUPERVISORS AND ALL PERSONNEL MUST LEARN AND PRACTICE THE PRINCIPLES OF SAFE OPERATION CONTAINED IN THE MANUAL.
- ENSURE THAT NATIONAL AND LOCAL SAFETY REGULATIONS, PRECAUTIONS, AND OTHER INSTRUCTIONS ARE FOLLOWED WHEN THE MACHINE IS USED.
- INSPECT THE WORK PLATFORM AND ARCH BEFORE, DURING, AND AFTER EACH USE IN ACCORDANCE WITH THE MAINTENANCE SECTION OF THE MANUAL.

USE REFRACTORY MANUFACTURES RECOMMENDED JACKING PRESSURE

USE REFRACTORY MANUFACTURES RECOMMENDED JACKING PRESSURE

WARNING

OVERLOADING THE DECK MAY CAUSE INSTABILITY AND STRUCTURAL FAILURE

WARNING

OVERLOADING THE DECK MAY CAUSE INSTABILITY AND STRUCTURAL FAILURE

WARNING

OVERLOADING THE DECK MAY CAUSE INSTABILITY AND STRUCTURAL FAILURE

WARNING

OVERLOADING THE DECK MAY CAUSE INSTABILITY AND STRUCTURAL FAILURE

WARNING

OVERLOADING THE DECK MAY CAUSE INSTABILITY AND STRUCTURAL FAILURE

DEOR - FDMOR SMALL

CROSS TUBE	LEFT	RIGHT	B RIGHT	B RIGHT
DECK SUPPORT	LEFT	RIGHT	B LEFT	B LEFT
DECK SUPPORT	LEFT	RIGHT	B LEFT	B LEFT
TIE BEAM	FRAME	FRAME	B LEFT	B LEFT
TIE BEAM	FRAME	FRAME	B LEFT	B LEFT
TIE BEAM	FRAME	FRAME	C RIGHT	C LEFT
TIE BEAM	FRAME	FRAME	C RIGHT	C LEFT
TIE BEAM	FRAME	FRAME	C RIGHT	C LEFT
LADDER	RAIL	RAIL	C RIGHT	C LEFT
LADDER	RAIL	RAIL	C RIGHT	C LEFT
LADDER	RAIL	RAIL	F	F

NOTICE

REMOVE PIN BEFORE ADJUSTING LEG HEIGHT IS SET
REINSERT PIN AFTER LEG HEIGHT IS SET

NOTICE

REMOVE PIN BEFORE ADJUSTING LEG HEIGHT IS SET
REINSERT PIN AFTER LEG HEIGHT IS SET

NOTICE

REMOVE PIN BEFORE ADJUSTING LEG HEIGHT IS SET
REINSERT PIN AFTER LEG HEIGHT IS SET

NOTICE

REMOVE PIN BEFORE ADJUSTING LEG HEIGHT IS SET
REINSERT PIN AFTER LEG HEIGHT IS SET

NOTICE

REMOVE PIN BEFORE ADJUSTING LEG HEIGHT IS SET
REINSERT PIN AFTER LEG HEIGHT IS SET

1 YEAR SPARE PARTS— 4M-6M bricking machines

Qty	Part #	Description
1	1885	MASTER VALVE, ASSEMBLY, PLACING ARCH, BLUE
2	1918	KIT, MASTER VALVE, REBUILD, O-RING REPLACEMENT, BLUE
2	1900	SPACER, ASSEMBLY, FLEX BEARINGS, AL ACME SCREW, WITH FASTENERS, KIT
10	1791	ROTARY VALVE, CYLINDER, HDPE, BLUE
10	1912	HOSE, 3/8 OD, BLUE, POLY
4	1856	CYLINDER, ASSEMBLY, 40MM X 8.0", AL, BLUE, WITH FASTENERS AND HANDLE
2	1870	BUMPER, 5.8 X 1.5 X 1.3, 65A DIR, ROD MOUNT
2	1928	KIT, ROTOR REPLACEMENT, VALVE IN BASE CYLINDER
1	1977	TOOL, SPRING DEPRESSOR, CLAMP, STEEL
15	1978	PIN, LINCH, 3/16 RING, YELLOW ZINC
15	1606	PIN, HITCH, 5/8 X 5.0

2 YEAR SPARE PARTS— 4M-6M bricking machines

Qty	Part Number	Description
1	1885	MASTER VALVE, ASSEMBLY, PLACING ARCH, BLUE
1	1886	MASTER VALVE, ASSEMBLY, HOLDING ARCH, BLUE
2	1918	KIT, MASTER VALVE, REBUILD, O-RING REPLACEMENT, BLUE
2	1900	SPACER, ASSEMBLY, FLEX BEARINGS, AL ACME SCREW, WITH FASTENERS, KIT
1	1848	LUBE FILTER, OILER, REGULATOR, ASSEMBLY, WITH CHECK VALVE
20	1791	ROTARY VALVE, CYLINDER, HDPE, BLUE
20	1912	HOSE, 3/8 OD, BLUE, POLY
6	1869	CYLINDER, 40MM X 8.0", VALVE IN BASE, AL BLUE
4	1870	BUMPER, 5.8 X 1.5 X 1.3, 65A DIR, ROD MOUNT
4	1928	KIT, ROTOR REPLACEMENT, VALVE IN BASE CYLINDER
1	1977	TOOL, SPRING DEPRESSOR, CLAMP, STEEL
30	1978	PIN, LYNCH, 3/16 RING, YELLOW ZINC
30	1606	PIN, HITCH, 5/8 X 5.0



SUPPLIED SPARE PARTS— 4M-6M bricking machines

Qty	Part Number	Description
2	1911	HOSE, 3/8 OD, RED, POLY
6	1912	HOSE, 3/8 OD, BLUE, POLY
1	1950	AM6 Dixon Air King Coupling
1	1918	KIT, MASTER VALVE, REBUILD, O-RING REPLACEMENT, BLUE
1	1928	KIT, ROTOR REPLACEMENT, VALVE IN BASE CYLINDER
1	1983	OIL, AIR TOOL, 15OZ, ISO 32
1	1899	OIL, HYDRAULIC, 15 LF OZ, 443mL, ISO 32
1	1856	CYLINDER, ASSEMBLY, 40MM X 8.0", AL, BLUE, WITH FASTENERS AND HANDLE
2	2056	PIN, 3/8 X 2 1/2(USABLE),BALL DETENT, SS 18-8, WITH LANYARD
2	1258	CARRIAGE BOLT, M10-1.50 x 30mm, STEEL, CLASS 8.8, ZINC PLATED
2	2058	WASHER, BELLEVILLE SPRING LOCK, 3/8, STEEL
1	1790	TOOL BOX, 19 X 10 X 9, BLACK
2	1972	HAMMER, DEAD BLOW, 4 LB, NEON ORANGE
1	1977	TOOL, SPRING DEPRESSOR, CLAMP, STEEL
1	1979	TOOL, HEX KEY, 5/32, BLACK PHOSPHATE STEEL, L SHAPE
1	1980	TOOL, HEX KEY, 1/8, BLACK PHOSPHATE, STEEL, L SHAPE
1	1788	PLIERS, LONG NOSE, 8"
2	1787	ALIGNMENT TOOL, 5/16 X 12"
1	1907	TOOL, SPEED WRENCH
1	2512	SOFT FACE DEAD BLOW HAMMER, 3LB

MISCELLANEOUS

PART #	DESCRIPTION
1914	HOSE, 3/4 ID, BARB-TITE, BLUE, 1200 PSI BURST, 300 PSI MAX, 1 1/16"OD
1915	HOSE, 5/8 ID, BARB-TITE, BLUE, 1200 PSI BURST, 300 PSI MAX, 15/16"OD
1984	JACK, HYDRAULIC, 2 TON, WITH PUMP



2777—RETRO FIT BARBED FITTINGS REPLACEMENT KIT

QTY	PART #	DESCRIPTION
4	1758	RETRO FIT BARBED FITTINGS REPLACEMENT
4 FT	1912	HOSE, 3/8 OD, BLUE POLY



If your machine has CF001 barbed fittings or CB205 manifold coupler block, we have a new retro fit part that can connect these fittings to the AF103S quick connect.





HWS—HARDWARE KITS



Hardware kits are based on machine serial number. Machine serial number is required with hardware kit order



Machine Number Location

VALVE SYSTEM

3134— ECOR MASTER VALVE ASSEMBLY, HOLDING ARCH

2068	ECON-O-RING MASTER VALVE BLOCK
1838	FITTING, MUFFLER, 1/4 NPTM, BRONZE ELEMENT
1960	FITTING, ELBOW, 1/4 NPTM - 1/2 TUBE, 90°, SWIVEL, BRASS
1955	FITTING, ELBOW, 1/4 NPTM - 1/4 TUBE, 90°, SWIVEL, BRASS

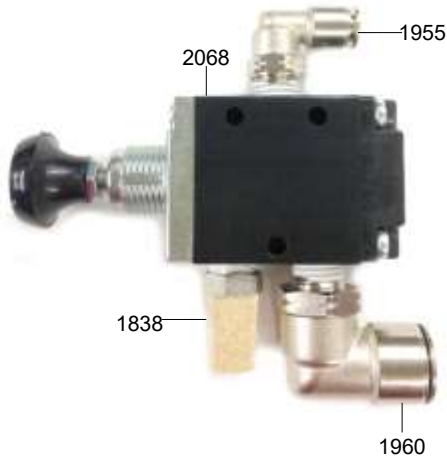

3135— ECOR MASTER VALVE ASSEMBLY, PLACING ARCH

2068	ECON-O-RING MASTER VALVE BLOCK
1838	FITTING, MUFFLER, 1/4 NPTM, BRONZE ELEMENT, STEEL
1959	FITTING, ELBOW, 1/4 NPTM - 1/2 TUBE, BRASS
1955	FITTING, ELBOW, 1/4 NPTM - 1/4 TUBE, 90°, SWIVEL, BRASS

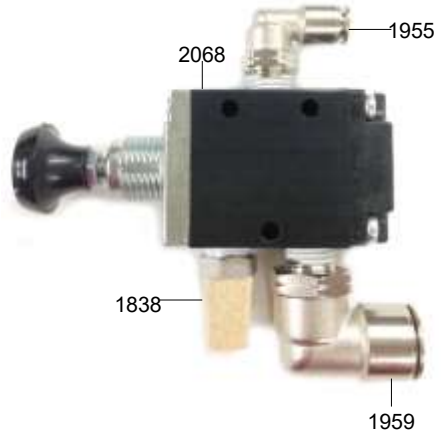

LUBRICATOR SYSTEM



PART #	DESCRIPTION
1953	FITTING, UNION TEE, 1/2 TUBE x 1/2 TUBE x 1/2 TUBE, BRASS



1848—LUBE FILTER, OILER, REGULATOR, ASSEMBLY, W/CHECK VALVE

1849	FITTING, ADAPTOR CROWFOOT TO, 1/2 NPTM, STEEL
1850	FITTING, 1/2 NPTM TO, 1/2 NPTF, 45° ELBOW, BRASS
1851	LUBE FILTER, OILER, REGULATOR, ASSEMBLY, WITH MOUNTS
1852	FITTING, CHECK VALVE, 1/2 MPTF TO, 1/2 NPTF, BRASS, ONE WAY VALVE
1853	FITTING, 1/2 NPTM PIPE NIPPLE, 1 1/2 LONG, BRASS
1854	FITTING, MUFFLER, 3/8 NPTM
1844	FITTING, 1/2 PUSH LOCK TO, 1/2 NPTM, 90°, SWIVEL



HOSES

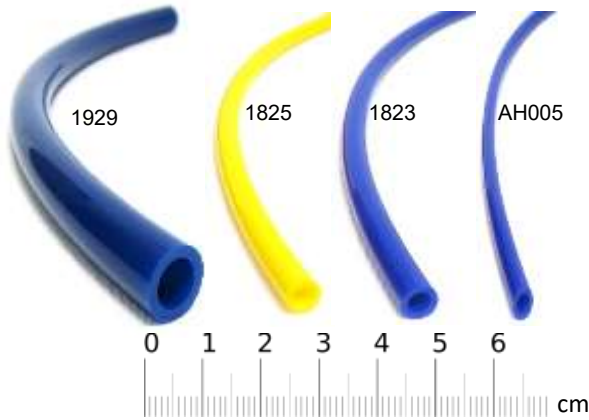

PART #	DESCRIPTION
1929	HOSE, 1/2 OD, POLY, BLUE (MASTER VALVE / LUB FILTER)
1825	HOSE, 1/4" OD, YELLOW, POLY (CYLINDER JUMP)
1823	HOSE, 1/4" OD, BLUE, POLY (CYLINDER)
AH005	HOSE, 1/8" OD, BLUE, POLY (MASTER VALVE)

MISCELLANEOUS PARTS



PART #	DESCRIPTION
2319	CASTER, SWIVEL, 6.0" X 2.0", PLASTIC, GREY
2073	WHEEL, ECON, 4", STEEL, BLACK
2065	GAUGE, AIR, 0-200 PSI, 1/8 NPTM

OLD FITTINGS PARTS



PART #	DESCRIPTION
1417	FITTING, COUPLING, 1/4 NPTF, BRASS
1958	FITTING, STRAIGHT, 3/8 NPTM - 1/2 TUBE, BRASS, NICKEL PLATED
OT924	Econo Reducer 1109x2x4
2087	FITTING, UNION, Y
1954	FITTING, ELBOW, 1/8 NPTM - 1/4 TUBE, 90°, SWIVEL, BRASS, PLASTIC COVERED
1962	FITTING, RUN TEE, 1/4 NPTF - 1/4 NPTF - 1/4 NPTM, BRASS
1933	FITTING, NIPPLE, 1/4 NPTM X 0.875, BRASS
1842	MALE CONNECTOR
1952	FITTING, TEE, 1/8 NPTM - 1/8 PUSH LOCK TUBE, BRASS, PLASTIC COVERED

2060—CYLINDER, ASSEMBLY, 4.0", SPRING RETURN, WITH TOGGLE SWITCH AND FITTINGS
PREVIOUS BSS # ASM006



2060—CYLINDER, ASSEMBLY, 4.0", SPRING RETURN, WITH TOGGLE SWITCH AND FITTINGS

2059	CYLINDER, 4.0" SPRING RETURN, HEX SHAFT, NO VALVE
2064	BUMPER, ECON-O-RING
2061	FITTING, HEX NIPPLE, 1/8 NPTM - 1/8 NPTM, BRASS
2062	SWITCH, TOGGLE, 1/8 NPTF - 1/8 NPTF, 2 POSITION - 2 WAY, AIR
2063	FITTING, ELBOW, 1/8 UNPTM - 1/4 TUBE, 90°, SWIVEL, BRASS, NICKEL
2069	FITTING, UNION TEE, 1/4 TUBE - 1/4 TUBE - 1/4 TUBE, BRASS, NICKEL
1823	HOSE, 1/4" OD, BLUE, POLY
1667	SCREW, SHC, 10-32 X 1

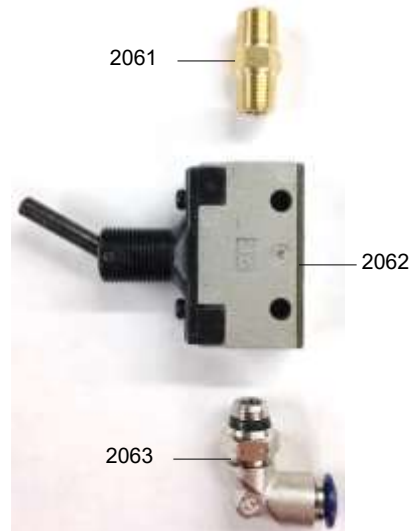



SUPPLIED SPARE PARTS

Qty	Part #	Description
1	2060	CYLINDER, ASSEMBLY, 4.0", SPRING RETURN, w/ TOGGLE SWITCH & FITTINGS
1	2069	FITTING, UNION TEE, 1/4 TUBE - 1/4 TUBE - 1/4 TUBE, BRASS, NICKEL PLATED
2	1823	HOSE, POLY, 1/4" OD, BLUE
1	1983	OIL, AIR TOOL, 15OZ, ISO 32
1	1950	FITTING, COUPLER, CROWFOOT - 3/4 BARBED, STEEL, ZINC PLATED
1	2309	1700k CASTER BRAKE ASSEMBLY
8	1492	SCREW, HHC, 3/8-16 X 4.0
8	1227	NUT, WING, 3/8—16

2 YEAR SPARE PARTS

Qty	Part #	Description
1	1848	LUBE FILTER, OILER, REGULATOR, ASSEMBLY, w/ CHECK VALVE
1	1896	PUMP, MANUAL / HYDRUALIC, 10,000 PSI
1	2070	CYLINDER, 10 TON, HYDRAULIC, 2" STROKE, 2.24 BORE
1	2088	HOSE ASSEMBLY, HAND PUMP KEYING JACK, 10'
2	2059	CYLINDER, 4.0" SPRING RETURN, HEX SHAFT, NO VALVE
1	2068	ECON-O-RING MASTER VALVE BLOCK
2	1870	BUMPER, 5.8 x 1.5 x 1.3, 65A DIR, ROD MOUNT
1	2087	FITTING, UNION, Y (ECONO RING)
4	2069	FITTING, UNION TEE, 1/4 TUBE, BRASS, NICKEL PLATED
4	1937	FITTING, REDUCER, 1/8 TUBE - 1/4 TUBE, PLASTIC
1	1960	FITTING, ELBOW, 1/4 NPTM - 1/2 TUBE, 90°, SWIVEL, BRASS, NICKEL PLATED
4	1954	FITTING, ELBOW, 1/8 NPTM - 1/4 TUBE, 90°, SWIVEL, BRASS, NICKEL PLATED
2	1838	FITTING, MUFFLER, 1/4 NPTM, BRONZE ELEMENT, STEEL, ZINC PLATED
2	1823	HOSE, POLY, 1/4 OD, BLUE
1	1983	OIL, AIR TOOL, 15 fl. oz., ISO 32
1	1899	OIL, HYDRUALIC, 15 fl.oz., ISO 32

PART #	DESCRIPTION
2827	BELT, CONVEYOR, 12 IN WIDE BY 20 FT LONG W/ PINS
CB022	BELT, CONVEYOR, 20 IN WIDE BY 20 FT LONG W/ PINS
CL001	BELT LACE, CONVEYOR
CL002	LACE PINS, CONVEYOR BELT
CBK012	SPLICE KIT, CONVEYOR 12 IN WIDE. INCLUDES LENGTHS OF: 6, 12, 18, 24, 30, 36 IN AND PINS
CBK020	SPLICE KIT, CONVEYOR 20 IN WIDE. INCLUDES LENGTHS OF: 6, 12, 18, 24, 30, 36 IN AND PINS
2841	CHAIN SPROCKET, 1 1/4 IN BORE, 18 TEETH, CONVEYOR
2842	CHAIN SPROCKET, 1 1/4 IN BORE, 12 TEETH, CONVEYOR
2797	MOUNTED BEARING, CONVEYOR, 1 1/4 IN SHAFT DIAMETER
2471	CONVEYOR TRACKING ADJUSTER WITH HARDWARE
2843	ROLLER CHAIN, CONVEYOR
CI016	CONVEYOR 15 1/4in IDLER ROLLER
2802	IDLER ROLLER, 1.9 X 8.0, CONVEYOR, SS HEAVY
2825	LEG, CONVEYOR, 36 IN
2799	CONVEYOR EXTENSION SECTION, 12 IN WIDE 10 FT LONG
CNVEXT20	CONVEYOR EXTENSION SECTION, 20 IN WIDE 10 FT LONG
CNV EMG	EMERGENCY STOP SWITCH, CONVEYOR



2827 / CB022



CBK012 / CBK020



2825



CL001 / CL002



CNV EMG ST



2843

2841

2842

2797



2471



CI016



2802



2799 / CNVEXT20

Conveyor Parts



PART #	DESCRIPTION
2431	SCREW, FHSC, 3/8-16 x 3.5, STEEL, ZINC PLATED
2430	SCREW, FHSC, 3/8-16 x 3.0, STEEL, ZINC PLATED
1239	SCREW, HHC, 1/2-13 x 2, GRADE 5, ZINC
1612	SCREW, HHC, 1/2-13 x 1.375, GRADE 5, ZINC
1238	WASHER, SPLIT LOCK, 1/2, ZINC
1633	NUT, HEX, NYLOCK, THIN, 1/2-13, ZINC
1240	NUT, HEX, 1/2-13, ZINC
1402	NUT, HEX, NYLOCK, 3/8-16, ZINC
2076	PIN, DOUBLE WIRE SNAP, 1/4 x 2.50, STEEL, ZINC PLATED
2832	CONVEYER SCISSOR JACK
CJ003	CONVEYOR SCISSOR JACK HANDLE



OLD PN	NEW PN	DESCRIPTION	ASM723	1865	MANIFOLD, ASSEMBLY, KEYING JAC
1927	1791	CYLINDER ROTARY VALVE	ASM724	1554	ASSY, FORK TRUCK BRACKET
A13	1930	THREADED SADDLE, ROD END CONVE	ASM760	1864	FOOT, KEYING JACK, ASSEMBLY
AB438	1902	BOLT, SPACER ASSEMBLY, 3/4-5 L	ASM790	1831	KEYING JACK, FOOT CONTROLLED
AC006	2059	CYLINDER, 4 IN S/R, HEX SHAFT	ASM800A	1796	KEYING JACK, FINGER TIP CNTL
AC46	1868	CYLINDER, 40MM x 6.0 IN, BLUE	ASM801	1861	HOSE, KEYING JACK, GAUGE
AC48	1869	CYLINDER, 40MM x 8.0 IN, BLUE	ASM830A	1857	HOSE ASSEMBLY, KEYING JACK, CO
AC733	1889	SHIM DRIVER HEAD, MILLED STEEL	ASM900	1894	SHIM DRIVER, KIT, 2 IN STROKE
AC761	1817	FOOT PAD, KEYING JACK, BLACK	AT009	1977	TOOL, SPRING DEPRESSOR, CLAMP,
AC762	1818	ROD END, 1 1/4 IN NPTF	AT122	1983	OIL, AIR TOOL, 15OZ
AF002	1849	COUPLER, CROWFOOT - 1/2 NPTM	AT439	1901	ANTI TURN, SPACER ASSEMBLY, AL
AF006	1950	COUPLER, CROWFOOT - 3/4 BARBED	ATC002	1976	TOOL, TIP, SPRING DEPRESSOR
AF018	1821	FITTING, 1/2 QDC MALE	AW384	1893	HOSE, ASSY, 1/2X10', SHIM DRIVER
AF074	1804	FITTING, 1/8 NPTM - 1/4 TUBE	BCB001	1870	BUMPER, 5.8 x 1.5 x 1.3
AF103S	1845	FITTING, ELBOW, 3/8 - 3/8 TUBE	CB021	2827	CONV BELT 12 X 20
AF139S	1840	FITTING, STRT, 3/8 - 3/8 TUBE	CB20	2797	MOUNTED BEARING, 1.25 IN, CONV
AF139S	1840	FITTING, STRT, 3/8 - 3/8 TUBE	CE250	1873	E-CLIP, 3/16, EXTERNAL
AF252	2061	FITTING, HEX NIPPLE, 1/8 NPTM	CH006	1877	HANDLE, CYLINDER ROTARY VALVE
AF268	1853	FITTING, NIPPLE, 1/2 NPTM	CH022	1913	HOSE, ASSM, CROSS OVER
AF421	1819	FITTING, 3/8 BARB - 1/2 NPTM	CH604	1828	FITTING, COUPLER, 3/8 HI-FLO
AF426	1888	FITTING, 1/2 BARB - 3/8 NPTM	CI001	CI001	ASSY, CONV IDLER 4.5 IN OD
AF429	1948	HOSE END, 3/4 BARB - 1/2 NPTM	CI008	2802	IDLER ROLLER, 1.9 X 8, CONV
AF432	1820	FITTING, 3/8 BARB - 1/4 NPTM	CJ001	2832	SCISSOR JACK, CONV
AF446	1838	FITTING, MUFFLER, 1/4 NPTM	CP005	1923	PIN, 0.125 x 0.75, SS
AF447	1854	FITTING, MUFFLER, 3/8 NPTM	CR006	1871	ROD, ANTI-TURN, 6 IN CYLINDER
AF450	1839	FITTING, PLUG, 1/2 NPT, HEX	CR008	1872	ROD, ANTI-TURN, 8 IN CYLINDER
AF508	1850	FITTING, PIPE ELBOW, 1/2 NPT	CS001	1924	SHAFT, ROTARY VALVE
AF544	1809	FITTING, ADAPT, 1/4 - 1/4 JICM	CS004	1926	SPRING, 0.480 OD x 0.75 FREE
AF684	1806	FITTING, HYDR, 1/4 - 1/4 JIC	CS60B12	2842	CHAIN SPROCKET, 12 TEETH, CONV
AF734	1803	FITTING, 1/8 NPTM - 1/4 TUBE	CS60BS18	2841	CHAIN SPROCKET, 18 TEETH, CONV
AF739	1841	FITTING, 1/2 QDC FEMALE	CSG001	2794	SIDE GUIDE, DRIVE, CONV
AF902	1826	SLEEVE, HOSE WELTING, 2.50 ID	CT000	2840	WHEEL, CONV
AG160	1968	GAUGE, AIR, 160 PSI, 1/4 NPTM	CT000	ct000	WHEEL, CONV
AH001	1823	HOSE, 1/4 IN OD, BLUE, POLY	CV004	1852	FITTING, CHECK VALVE, 1/2 MPTF
AH002	1824	HOSE, POLY, 1/4 IN OD, RED	CVL036	2825	LEG 1, CONV, 36 IN
AH003	1825	HOSE, POLY, 1/4 IN OD, YELLOW	CW002	1925	WASHER, ROTARY VALVE
AH004	1912	HOSE, 3/8 OD, BLUE, POLY	GA300	1798	MANIFOLD, 3/8 NPTM-1/4 NPTF
AH006	1911	HOSE, 3/8 OD, RED, POLY	HC159	1810	CYLINDER, 10 TON, 6 IN STROKE
AH394	1887	AIR HAMMER, RD SHANK, RED	HG1	2803	HARD PLASTIC, 1.5 OD, CONV
AH430	1892	FITTING, 1/2 BARB - 1/2 NPTM	HG700	1808	GAUGE, OIL, 10,000 PSI
AH475	1862	HOSE ASSEMBLY, SUPPLY, 2'	HH104	1805	FITTING, HYDR, 1/4 NPTM - 1/4
AH604	1946	10 TON REG FLOW COUPLER	HJ317	1984	JACK, HYDRAULIC, 2 TON
AH732	1816	AIR HOSE, 3/8 IN ID, 21/32 OD	HJ318	1916	JACK, FLAT BOTTOM, 3 TON
AH733	1891	HOSE, 1/2 ID, BARB-TITE, BLUE	HJ318	1917	JACK, KNUCKLE BOTTOM, 3 TON,
AH735	1914	HOSE, 3/4 ID, BARB-TITE, RED	HK745	1979	TOOL, HEX KEY, 5/32
AH809	1929	HOSE, 1/2 OD, POLY, BLUE	HK746	1980	TOOL, HEX KEY, 1/8
AP132	1797	PUMP, AIR / HYDRAULIC, PENDENT	HM104	2830	HYDRAULIC MOTOR, CONV
AP141	1896	PUMP, MANUAL / HYDRUALIC	HO723	1899	OIL, HYDRAULIC, 15 OZ, ISO 32
AR400	1565	ASSY, ARCH HINGE	HP124	1210	PIN, HITCH, 1/2 x 4.25, Y.ZINC
AS001	1851	LUBE FILTER, OILER, REGULATOR	HP4	1568	PIN, ARCH HINGE
ASM4056S / ASM4056	1876	CYLINDER, ASSY, 6 IN, BLUE	HS903	1830	GUARD, SPRING, STEEL
ASM4058S/ASM4058	1856	CYLINDER, ASSY, 8 IN, BLUE	HSS36	1811	HOSE CLAMP, #28, 1.25 - 2.25
ASM450	1848	LUBE FILTER, OILER, REGULATOR,	HW001	1630	NUT, NYLOCK, 3/8-16
ASM450	1900	SPACER ASSEMBLY, FLEX BEARING	HW004	1619	NUT, HEX, 3/8-16
ASM453	1928	KIT, ROTOR REPLACEMENT	HW010	1867	SPACER, 5/16 OD x 3/8
ASM461	1918	KIT, MASTER VALVE, REBUILD	HW023	1683	SCREW, SHC, 10-32 x 1.5, SS
ASM463BS / ASM463B	1886	MASTER VALVE, ASSY, HOLDING, BLUE	HW024	1628	NUT, NYLOCK, 10-32
ASM463BS \ ASM463B	1846	MASTER VALVE, ASM, HOLDING	HW029	1931	SCREW, SET, 1/4-20 x 3/8, SS
ASM463FS / ASM463F	1885	MASTER VALVE, ASSY, PLACING BLU	HW031	1517	SCREW, HHC 5/8-11 X 9.0
ASM476	1863	HOSE ASSEMBLY, FOOT TREADLE KE	HW035	1629	NUT, NYLOCK, 1/4-20
ASM718	1898	HOSE, 3/8 NPTM X 10 FT, W/HIGH	HW043	1615	SCREW, HHC, 3/8-16 X 2.5



HW058	1636	SCREW, HHC, 1/2-13 X 4.5
HW074	1501	NUT, HEX 5/8-11 NYLOCK
HW075	1666	SCREW, SHC, 10-32 x 5/8
HW076	1667	SCREW, SHC, 10-32 x 1.0, SS
HW077	1663	SCREW, SHC, 10-32 x 2.0, SS
HW122	1613	NUT, WING, 1/2-13
HW125	1611	WASHER, FLAT, 3/8
HW126	1500	WASHER, FLAT, 5/8
HW134	1632	SCREW, HHC, 1/2-13 X 2.5
HW139	1662	PIN, SPRING, 3/32 X 1.25
HW142	1657	CARRIAGE BOLT, 3/8-16 X 3
HW144	1665	SCREW, SHC, 10-32 x 1/2, SS
HW154	1518	NUT, WING, 5/8-11
HW155	1623	NUT, HEX, 3/4-10
HW157	1617	WASHER, FLAT, 3/4
HW160	1612	SCREW, HHC, 1/2-13 X 1 3/8
HW194	1625	NUT, MACHINE SCREW, 10-32
JO680	1802	INTERNAL RETAIN RING, 11/16
LFC001	1477	GUARD, LUBE OIL FILTER
LJ101	1799	MANIFOLD, FINGER TIP CONTROL
LJ903	1800	VALVE, 3 WAY, CARTRIDGE
LJ904	1801	BUTTON, 0.1875 STEM, BRASS
LPB1	1855	ALARM, LOW AIR PRESSURE, 1/4 N
MB001A	1874	BRACKET, ANTI-TURN, ALUMINUM
MB002	1875	BUSHING, ANTI-TURN, SS
MK443	1843	KNOB, 1.375 OD, 1/4-20 x 7/16
MSC020	1974	CASTER, DUAL WHEEL, GREEN/RED
MV441	1878	MASTER VALVE, MANIFOLD, BLUE
MV441	1879	MASTER VALVE, BODY, BLUE
MV442	1880	MASTER VALVE, END CAP, BLUE
MV444	1881	MASTER VALVE, SHUTTLE
MV445	1883	O-RING, MASTER VALVE, LARGE
MV449	1882	O-RING, MASTER VALVE, SMALL
OT666	1908	FITTING, 1/4 NPTF - 3/8 TUBE
OT924	1937	REDUCER, 1/8 TUBE - 1/4 TUBE
OT988	1844	FITTING, STR, 1/2 - 1/2 TUBE
P15	1813	PIPE, 1 1/4 NPTM X 15 IN
P17	1814	PIPE, 1 1/4 NPTM X 17 IN
P19	1815	PIPE, 1 1/4 NPTM X 19 IN
P9	1812	PIPE, 1 1/4 NPTM X 9 IN
PA133	1827	PUMP, FOOT TREADLE
RC102	2070	CYLINDER, 10 TON, 2 IN STROKE
RC60	2843	ROLLER CHAIN, CONV
SA100	1904	BEARING, 1.0 ID, FACE MOUNT
SA340	1903	BEARING, 3/4 ID, FACE MOUNT
SCW020	2534	WHEEL, SAFETY CAGE, 20"
SS424	1890	SHANK, ROUND / ROUND, STEEL
SW729	1907	TOOL, SPEED WRENCH
TH310	1982	TOOL, HAMMER, RAWHIDE, 3LB
TS108	2062	SWITCH, TOGGLE, 1/8 NPTF
TS120	1905	SOCKET, 1/2 - 8pt x 1/2 DRIVE
TS340	2878	SOCKET, 22mm- 6pt x 1/2 DRIVE
VG001	1975	TOOL, VICE GRIPS, 11 IN, STEEL
VW300	1971	CASTOR, V-GROVE, 4 x 2 IN, BLK
VW600	1970	WHEEL, 2 X 6 IN, V-GROOVE, STL
W013	1633	NUT, NYLOCK, 1/2-13
WC124	1969	CASTER, 10 X 3, GREEN, SWIVEL

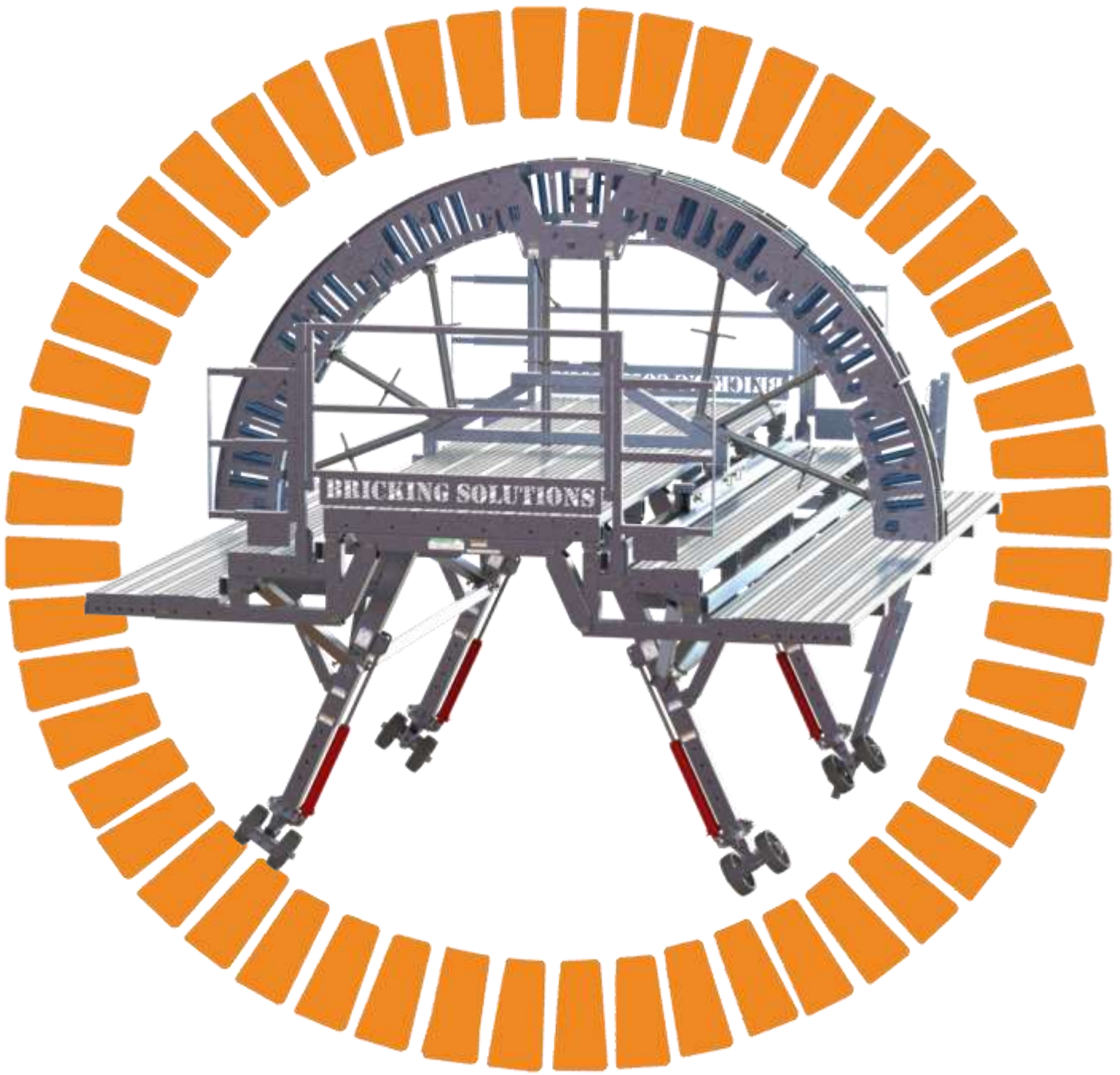

Bricking Solutions is the global leader in
Refractory Maintenance Products

Bricking Solutions, Inc.
1144 Village Way, Monroe, WA 98272 USA
+1-360-799-4767 | info@brickingsolutions.com | brickingsolutions.com